



Low Pressure Generator LPG-40

(Maximum Pressure: 40 psi (2.75 bar))
Vacuum: 20" Hg



Instructions for Use

- 1) Connect the hose to one side of the 3-way valve.
- 2) Connect the other side of the hose to the calibrator.
- 3) Connect another hose to the base fitting on the opposite side, connecting it to the instrument being calibrated.
- 4) Turn the knob clockwise to increase the pressure and counterclockwise to decrease the pressure or create a vacuum.
- 5) To release the pressure, turn the 3-way valve to
- 6) Do not use with liquids or external pressure.
- 7) Generator base is prepared for bench mounting.

PRESYS
www.presys.com.br

Rua Luiz da Costa Ramos, 260
São Paulo - SP - 04157-020
Tel: (11) 3056.1900
www.presys.com.br
vendas@presys.com.br



EF1009-00

Low Pressure Generator **LPG-40**

Features

- ❑ Ultra-high resolution.
- ❑ Excellent stability for low pressure calibrations.
- ❑ Dual O-rings.
- ❑ **Maximum pressure:** 40 psi (2.75 bar) Vacuum: 20" Hg.
- ❑ **Resolution:** 0.0005 psi (0.35 mmH₂O).
- ❑ **Approximate weight:** 1.6 kg.
- ❑ Can be mounted on a bench.
- ❑ Supplied with **PRESYS** hoses and fittings.
- ❑ **Volume:** 110 ml.
- ❑ 3-way valve 1/8" NPT.

****Supplied with carrying case.****

Optional

- ❑ 02 x High pressure hoses (code: 06.08.0018-00):
Construction: Polyamide with Kevlar braided outer layer.
Length: 900 mm.
Ends: Brass.
Maximum pressure: 6000 psi.
- ❑ 02 x Male adapter 1/4" NPT (code: 06.08.0006-00).

Dimensional Drawing

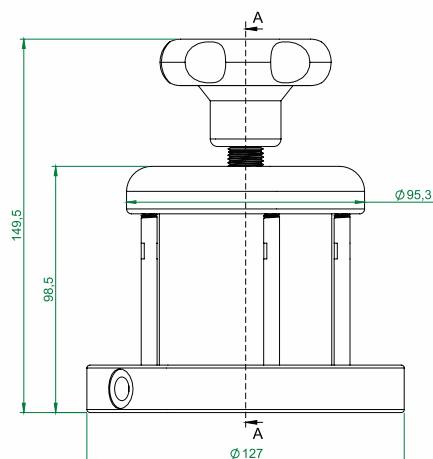

The information and specifications in this catalog are subject to change without prior notice.